

# NPN

New Product News



**WINCUT**  
ADVANCED PARTING



## New Triangular Blades and Blocks for Parting and Deep Grooving with Internal High-pressure Coolant

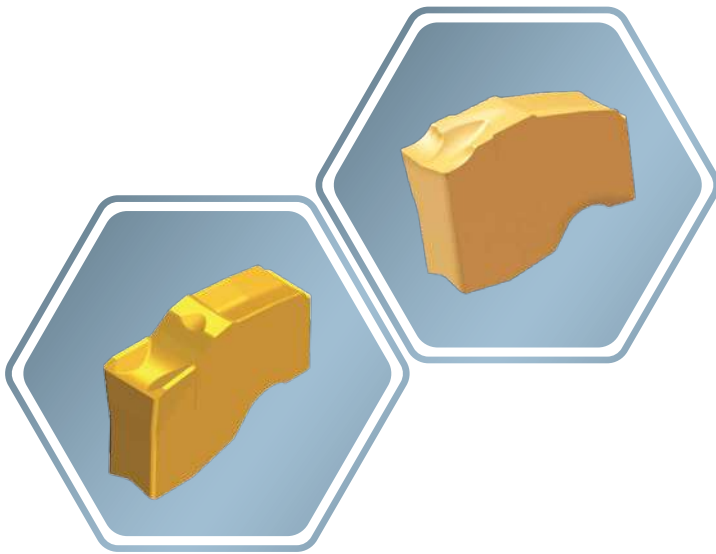

## KEY POINT

**TaeguTec introduces triangular blades and blocks to the WIN-CUT line for parting and deep grooving using internal high-pressure coolant.**

The new line, which includes blades with three insert pockets and dedicated blocks, WIN-CUT products enable very stable machining in parting and deep grooving applications. In either high feed or interrupted cutting conditions, WIN-CUT ensures an excellent surface finish with minimal vibration.

Reinforced blocks, designed to support the three insert pocket blades, firmly seat the blade on two sides (the drophead and the turret). The blades include internal through-coolant channels directed to the insert's cutting edge, significantly increasing productivity and tool life.

### Features

- Economical 3 insert pocket blade
  - Direct lubrication to the cutting zone from the blade's top and bottom coolant channels
  - Internal through-coolant channels for improved tool life in both parting and deep grooving applications
  - Excellent chip evacuation ensures stable machining and excellent surface finish
  - Maximum productivity in high-speed, high feed machining conditions
  - User-friendly insert clamping system
- High rigidity triangular blades and dedicated blocks
  - At least 3 times better rigidity comparing to conventional blade
- Triangular blades are compatible with CUT-SFEED and T-CLAMP inserts
- Compatible with a wide variety of machines including multitasking and general CNC machines
- Maximum diameter  $\varnothing 120$  mm bars can be cut with 2 and 3 mm width inserts to reduce material costs



## Rigidity: Triangular blade vs Conventional blade

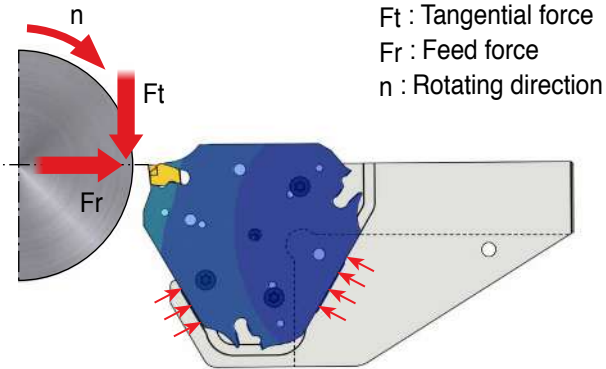

Triangular blade with enhanced rigidity and stable support structure  
(No vibration)

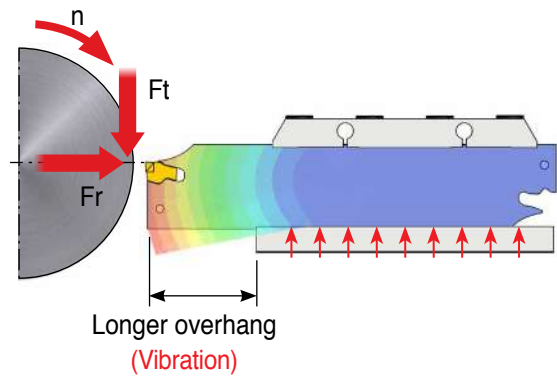

Conventional blade

## Directed coolant supply to the cutting zone

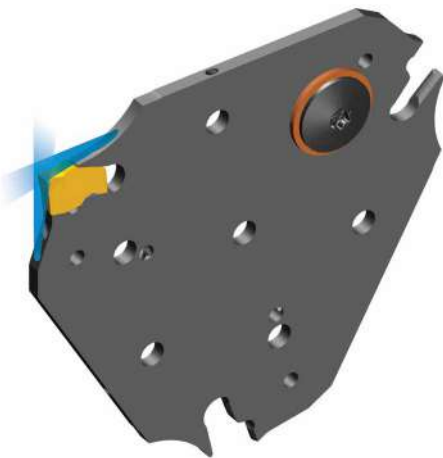

## Blocks with stable tightening and rigid support structures

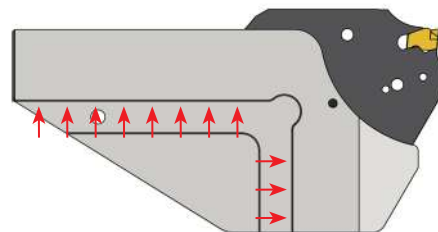

## SFTB



Triangular blades for parting and deep grooving

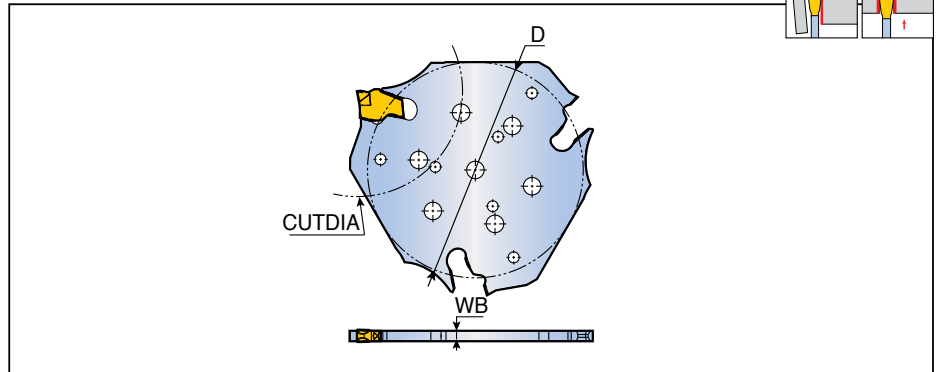
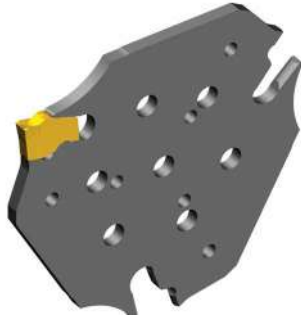

Designation	Insert seat size	Dimension (mm)			Block	Insert
		D	WB	CUTDIA		
<b>SFTB D52-2</b>	2	53.2	1.8	52	THTBR/L-TB	SFC SFJ
	3	53.2	2.5	52		
<b>D82-2</b>	2	64.3	1.8	82		
<b>D82-3</b>	3	64.3	2.5	82		
<b>D120-2</b>	2	85.5	1.8	120		
<b>D120-3</b>	3	85.5	2.5	120		

## SFTB-TB new



Triangular blades for parting and deep grooving with high-pressure coolant

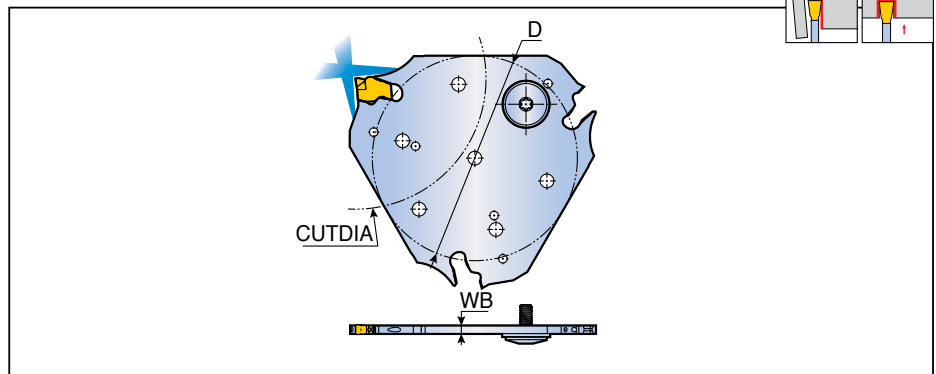

Designation	Insert seat size	Dimension (mm)			Block	Insert
		D	WB	CUTDIA		
<b>SFTB D52-2-TB</b>	2	53.2	1.8	52	THTBR/L-TB	SFC SFJ
	3	53.2	2.5	52		
<b>D82-2-TB</b>	2	64.3	1.8	82		
<b>D82-3-TB</b>	3	64.3	2.5	82		
<b>D120-2-TB</b>	2	85.5	1.8	120		
<b>D120-3-TB</b>	3	85.5	2.5	120		

## Spare parts

Designation	Sealing screw set	Extractor		
	<b>SFTB</b>	-	ETG 3-4	
<b>SFTB-TB</b>	SGC 340-Q	ETG 3-4		

▶ Extractor should be ordered separately

## TGTB



Triangular blades for parting and deep grooving

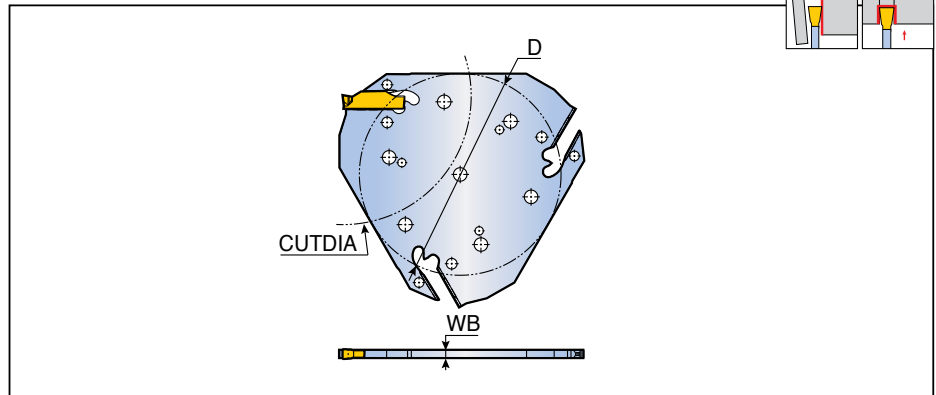
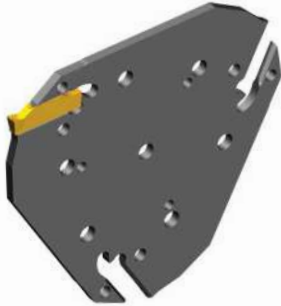

Designation	Insert seat size	Dimension (mm)			Block	Insert
		D	WB	CUTDIA		
<b>TGTB D52-2</b>	2	53.2	1.8	52	THTBR/L-TB	TDC/J TDXU/XT/XY/CT TSC/J TDUF/TDV
<b>D52-3</b>	3	53.2	2.5	52		
<b>D82-2</b>	2	64.3	1.8	82		
<b>D82-3</b>	3	64.3	2.5	82		

## TGTB-TB new



Triangular blades for parting and deep grooving with high-pressure coolant

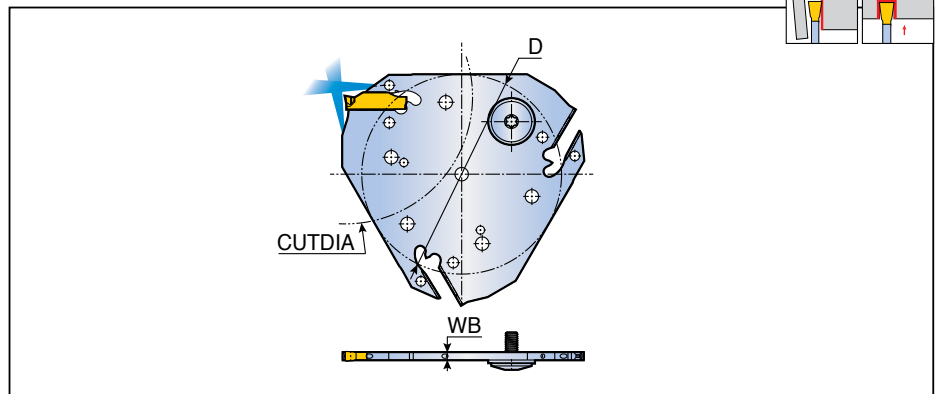

Designation	Insert seat size	Dimension (mm)			Block	Insert
		D	WB	CUTDIA		
<b>TGTB D52-2-TB</b>	2	53.2	1.8	52	THTBR/L-TB	TDC/J TDXU/XT/XY/CT TSC/J TDUF/TDV
<b>D52-3-TB</b>	3	53.2	2.5	52		
<b>D82-2-TB</b>	2	64.3	1.8	82		
<b>D82-3-TB</b>	3	64.3	2.5	82		

## Spare parts

Designation	Sealing screw set	Extractor		
	<b>TGTB</b>	-	EDG 33B	
<b>TGTB-TB</b>	SGC 340-Q	EDG 33B		

▶ Extractor should be ordered separately

## THTBR/L-TB



### Blocks for triangular blade

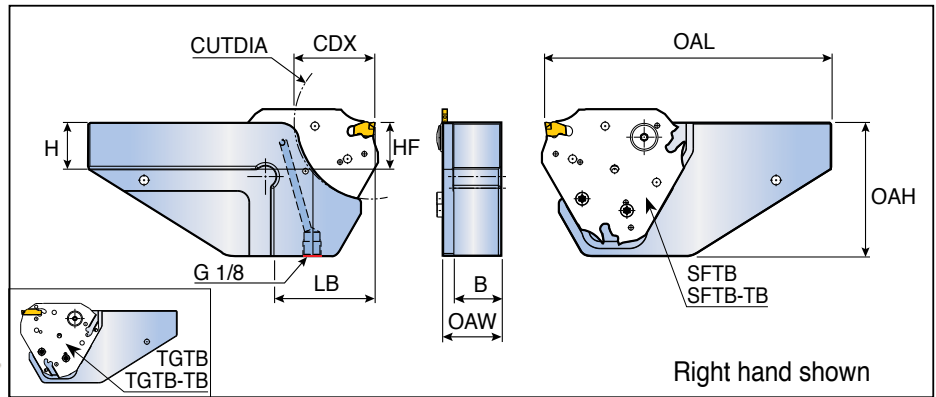

Designation	Dimension (mm)								Blade
	H	HF	B	OAL	OAH	OAW	LB	CUTDIA	
<b>THTBR/L 20-D52-TB</b>	20	20	17.5	125	52	23.5	40	52	SFTB/SFTB-TB TGTB/TGTB-TB
<b>20-D82-TB</b>	20	20	17.5	140	72	23.5	51.5	82	
<b>25-D52-TB</b>	25	25	22.5	135	52	28.5	40	52	
<b>25-D82-TB</b>	25	25	22.5	150	72	28.5	51.5	82	
<b>25-D120-TB</b>	25	25	22.5	165	95	28.5	67	120	
<b>32-D120-TB</b>	32	32	29.0	165	95	35.0	67	120	

- 1 Block: THTBR / L-TB
- 2 Blade: SFTB...(-TB) / TGTB...(-TB)
- 3 Locating pin: SIDE THRUST PIN 3MM
- 4 Screw: SH M4X0.7X10-TX
- 5 O-ring: O-RING ID10X2

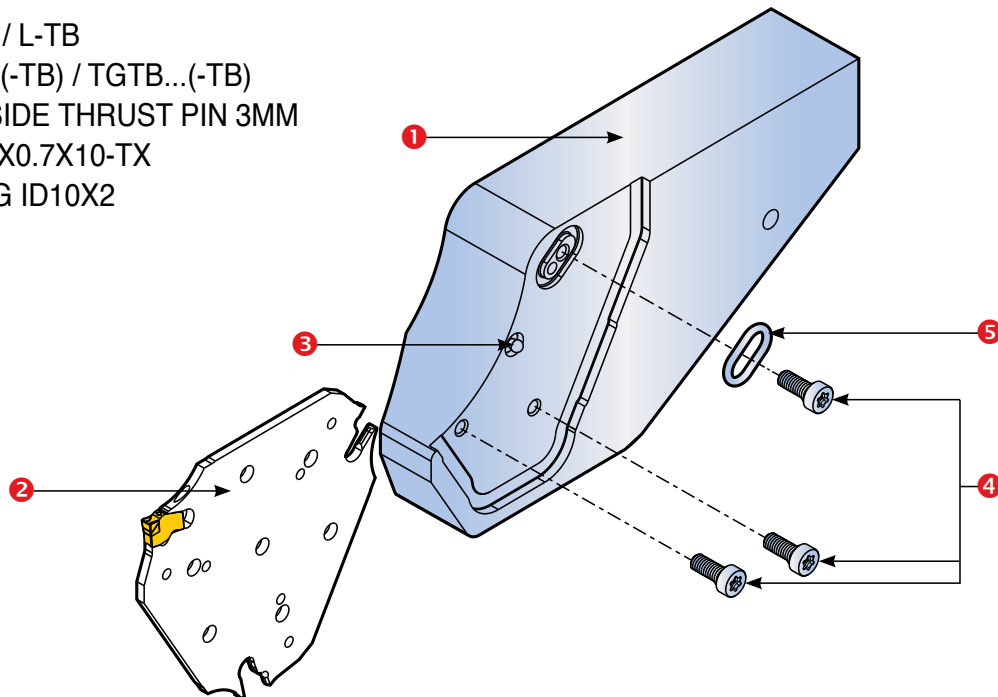

### Spare parts

Designation	Locating pin	Screw	O-Ring	Wrench
<b>THTBR/L-TB</b>	SIDE THRUST PIN 3MM	SH M4X0.7X10-TX	O-RING ID10X2	T 20